

- Gestaltungsplanpflicht
- - - - Geruchsemissionenabstände
- . - . Bereich für Bauten und Anlagen gemäss § 9a Abs. 2 BNO (2013)











- Abbruch
- Gehölzstrukturen

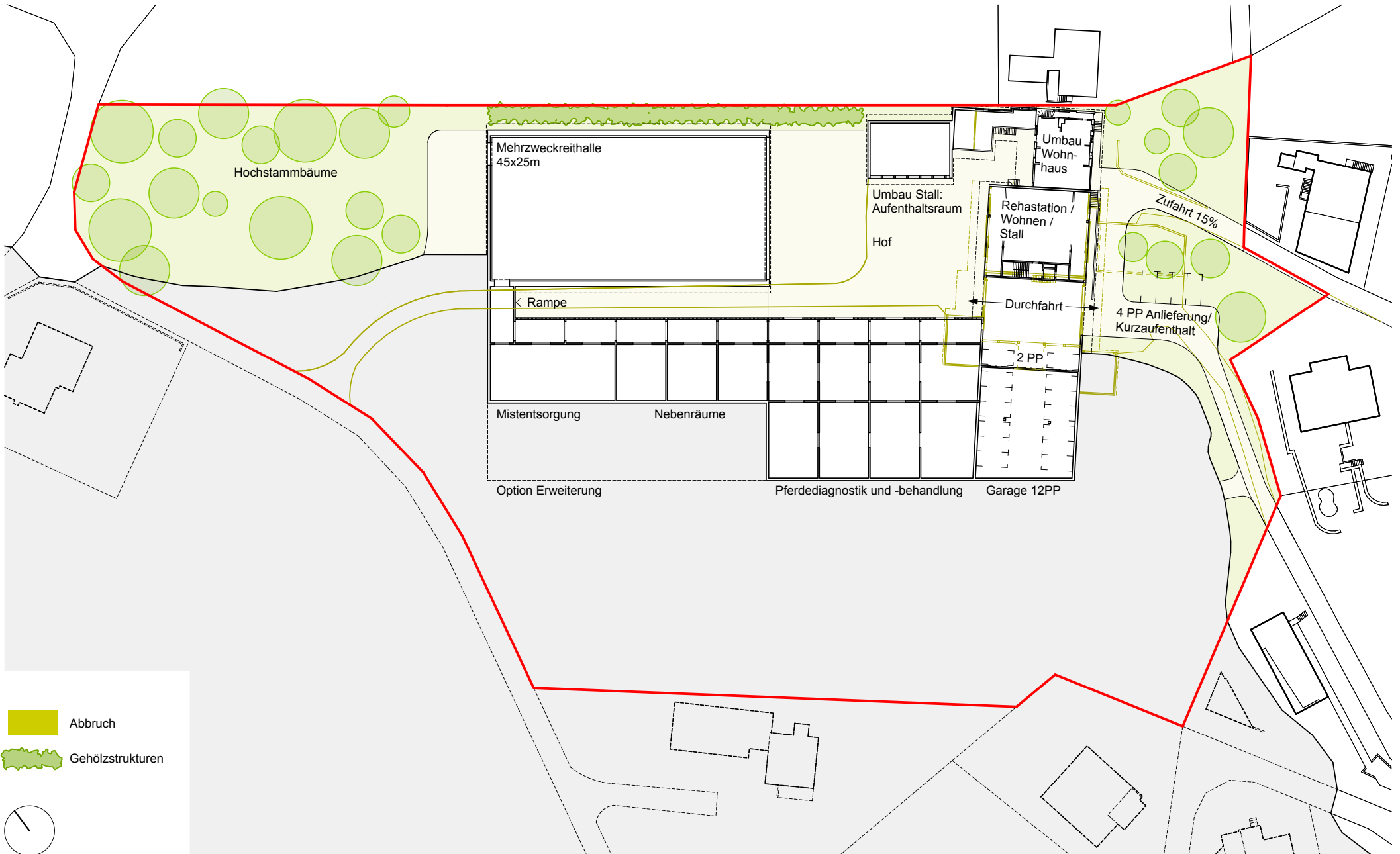

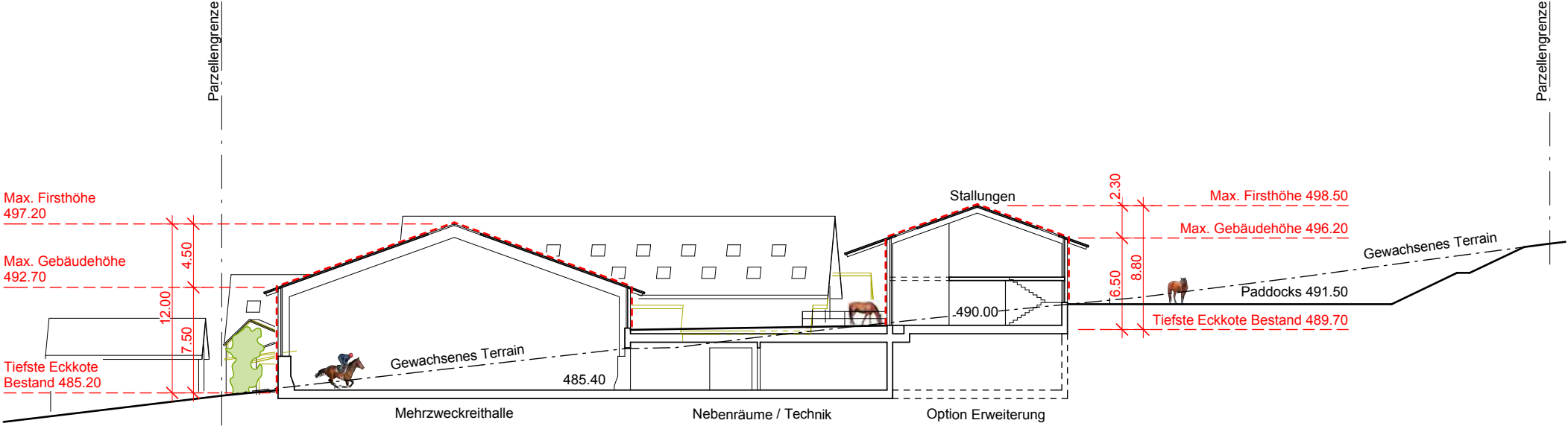



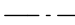

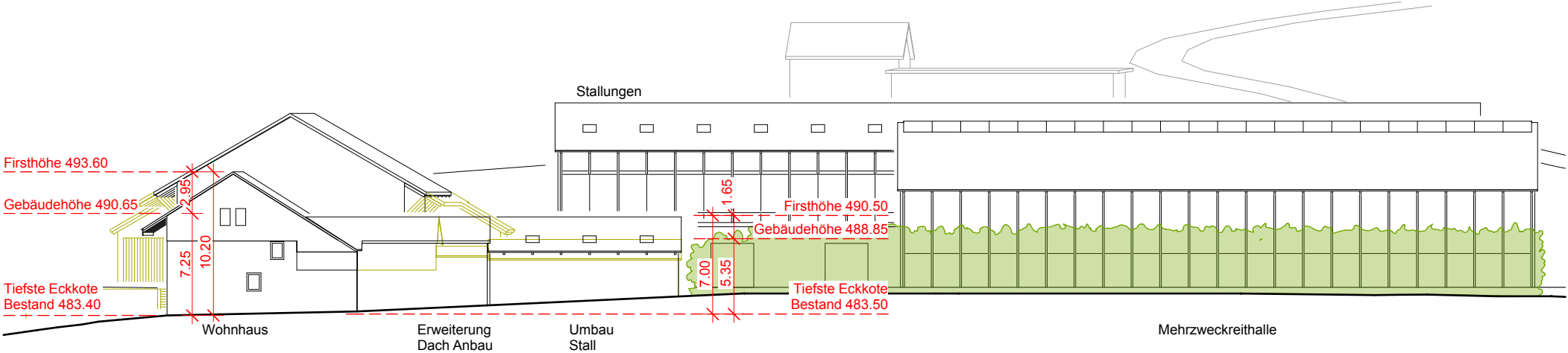
-  Mantelvolumen gemäss Gestaltungsplan
-  Abbruch
-  gewachsenes Terrain

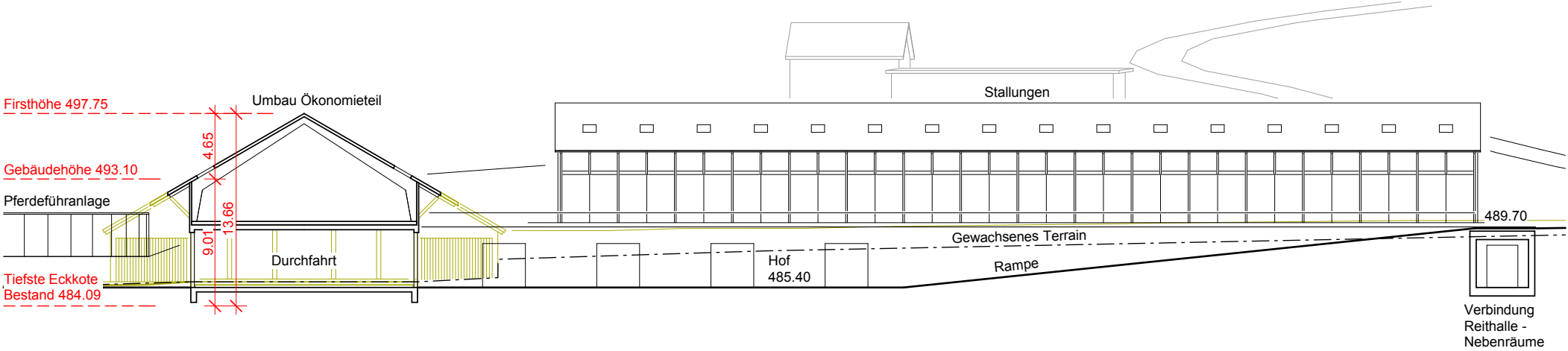

- Abbruch
- gewachsenes Terrain

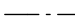

-  Abbruch
-  gewachsenes Terrain

